



# Building-in Sustainability

liveable solutions for a low-carbon future

adrian buffery  
development director



greenoak  
housing association

## session themes

1. Sustainability from a provider perspective
2. Greenoak's experience in greenhomes
3. Feedback on liveability in use
4. General indicators of success

# why ? – it's our business

- Integrating sustainability - it's not an optional extra

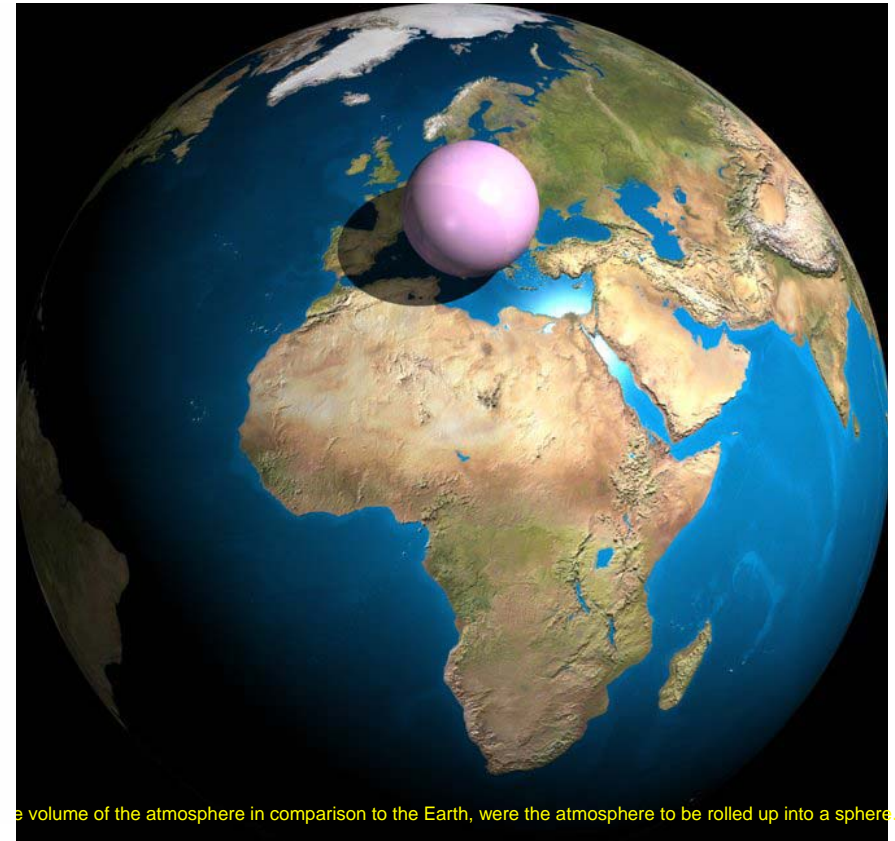
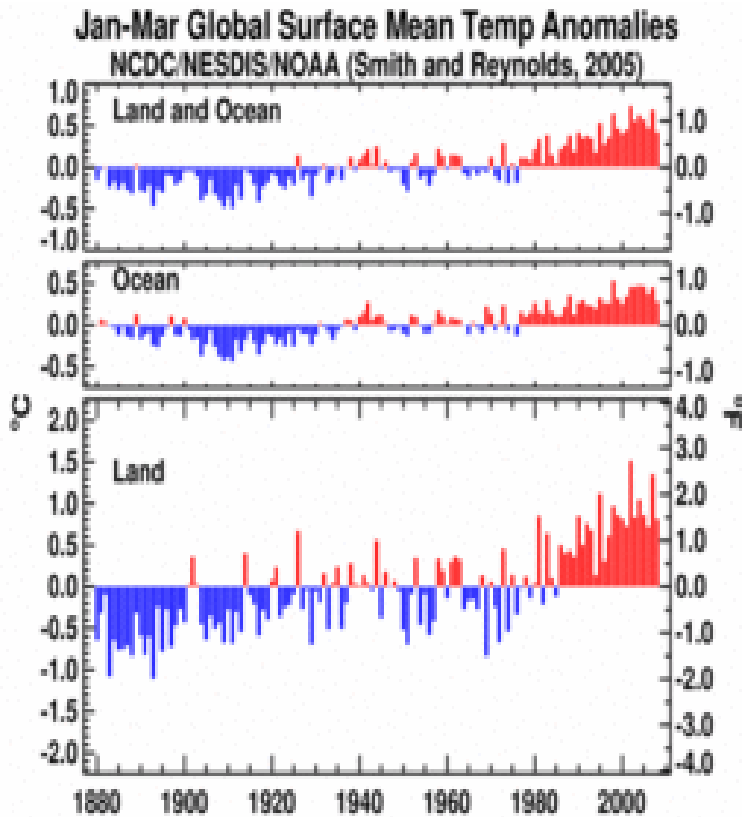

the volume of the atmosphere in comparison to the Earth, were the atmosphere to be rolled up into a sphere.

# a sustainable landlord ?

Are we building housing  
which meets residents needs  
& expectations?

Space standards

Light and warm

Quality of design & construction

Affordable & attractive – now / future



## how ? – setting up

- Organisational Commitment
- Quality and Value-led – beyond compliance ticking
- Integrated Design – avoid add-ons
- Measuring Outcomes – reducing the design/actual  
**gap**



# getting there – take action

- Use existing knowledge
- Tenant engagement
- Skilled design team
- Procurement approach
- Testing standards
- Learning ‘what works’



# delivering green homes

## Priorities:

- 1) Liveability
- 2) Energy saving
- 3) Waste avoidance
- 4) Value for the Future



# greenhomes

## Reduce energy use, pollution & fuel bills.

- High levels of insulation
- Triple glazing
- Airtight construction
- Avoid cold bridges through insulation
- Draught lobby
- No cold roofspace
- Plenty of daylight
- Low energy lighting

## Adaptable

- No load bearing interior partitions
- Services accessible for upgrading and alteration

## Accessible

- Wheel chair accessible
- Lifetime Homes standard

## Secure

- Secured by Design standards

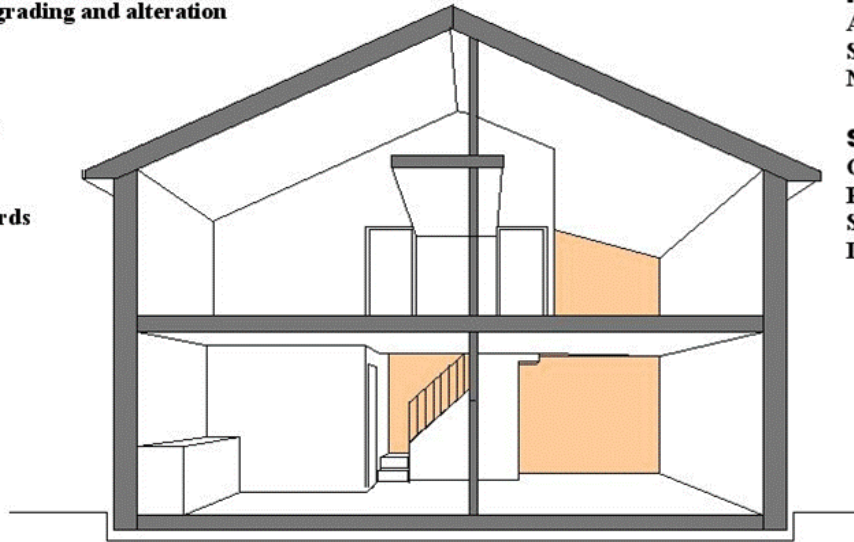

## Reduce water bills

- Low water use toilet
- Shower with efficient spray head
- Spray taps
- Water butt in garden

## Reduce waste

- Recycling bins provided
- Prefabricated structure
- Contractor to recycle waste on site

## Reduce maintenance

- Aluminium exterior to timber windows
- Self-coloured render
- No painting as natural finish to timber

## Sustainable specification

- Ozone friendly
- PVC free
- Sustainable timber
- Low environmental impact materials

Eco friendly houses

Greenoak Housing Association

Jon Broome Architects  
Sustainable Construction Consultants  
020 8291 9167



greenoak  
housing association

# rocket science?

- Easy to live in – for all
  - Passive approach – risk
  - Light and healthy
  - Spacious and flexible
  - Toxin-free, carbon light
  - Waste reduction
  - No water run off
- 
- Lifetime homes standard
  - Future-proofing design
  - Minimise lifetime costs



## getting there – take action

Reduce demand before  
greening the supply

Insulation & airtightness

Devil in the detail

Avoid cold bridging

Controlled ventilation

Ensure high build quality



# overcoming barriers

## Technology

- Design
- Supply
- Quality

## Psychology

- Buy-in
- Business planning
- User off-setting



## be interactive

Test and measure

Monitor actual power  
and water use

Talk to residents, staff  
and other stakeholders

Learn the lessons

Improve the model



**wind powered solar assisted renewable low carbon drying system**

-courtesy Prof. David Strong

## our homes



A sustainable landlord  
Comfortable, attractive,  
affordable homes  
Reduce consumption  
Allow easy upgrading  
Ensure long term demand



## feedback includes..



modern design, spacious rooms

low heating and water bills

warm and draft free

good natural light and sunlight

high quality fittings

useful mezzanine spaces

homely, feels safe



## feedback quotes..



greenliving

**“light and airy”**

**“it’s so spacious”**

**“before I moved in I thought I should buy a draught excluder, I’m glad didn’t!”**

**“warm... I could grow tomatoes in here!”**

**“...the energy bills are good and I can’t remember the last time we put the heating on”**

**“they have the Tardis effect – they don’t look that big from the outside but everyone who comes in is like ‘wow what a huge lounge’.”**

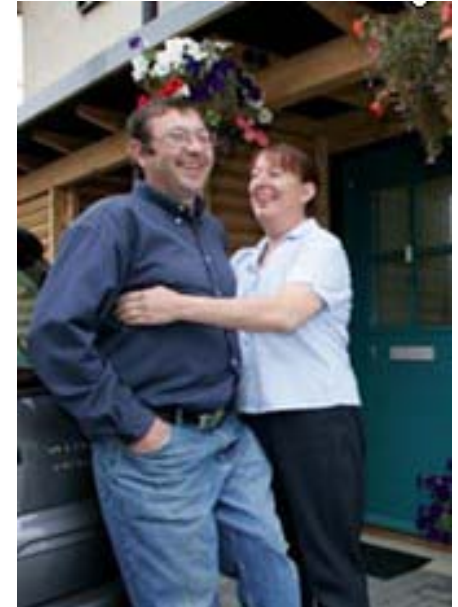

# liveability

health & wellbeing

*‘..air is much cleaner and fresher..’*

*‘....more space for the kids to play...they can have friends round ....’*

*‘Before I moved in here would get a cold every month, since I’ve moved in here I’ve had maybe 2 or 3 colds in 2 years.’*

*‘..seeing the sun in winter...it lifts you, you know...’*

*‘it’s good that the house can be adapted in the future...for my son...’*



# liveability



**greenoak**  
housing association

## resident satisfaction levels

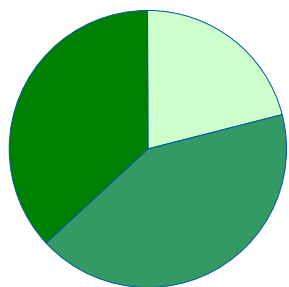

house layout

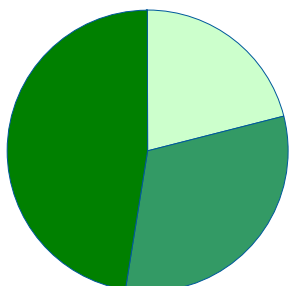

room size

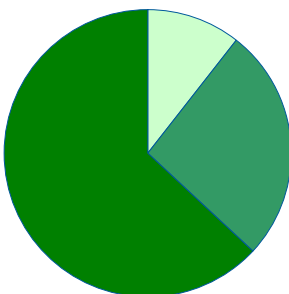

natural light

happier

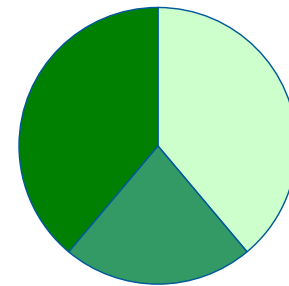

pride

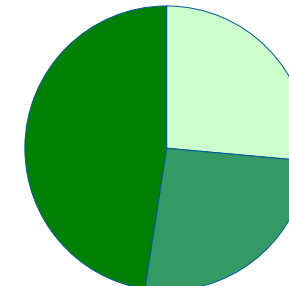

safe & secure

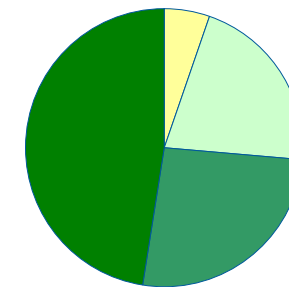

very low

low

satisfactory

high

very high

# passive savings

reducing gas consumption

high levels of insulation

250 – 300mm of recycled cellulose insulation in walls, floors and roofs giving a u-value of around 0.16

triple glazing

Giving overall u-value of 1.2

airtight construction

twice tested for airtightness giving 1.5 – 2.5 M<sup>3</sup>/m<sup>2</sup>/hr

heat recovery

85 % efficient air to air whole house ventilation



# passive savings

## Greenhomes gas use per household per year

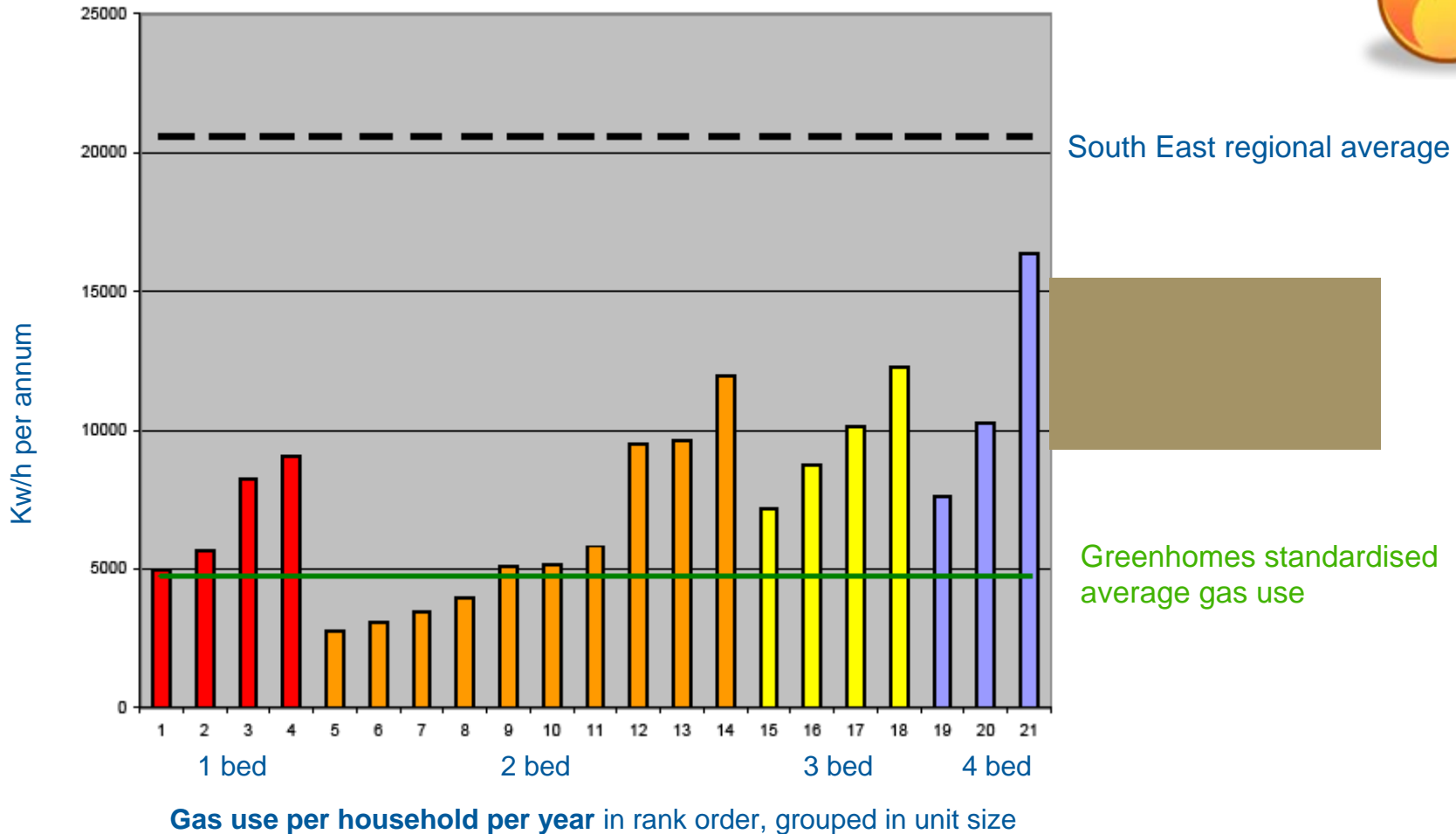

# passive savings

reducing water consumption

reduced flow fittings

Water efficient WC

Planning plumbing layout to avoid long runs

Omitting outside taps

Installing water butts



# passive savings

## Greenhomes water use per household per year

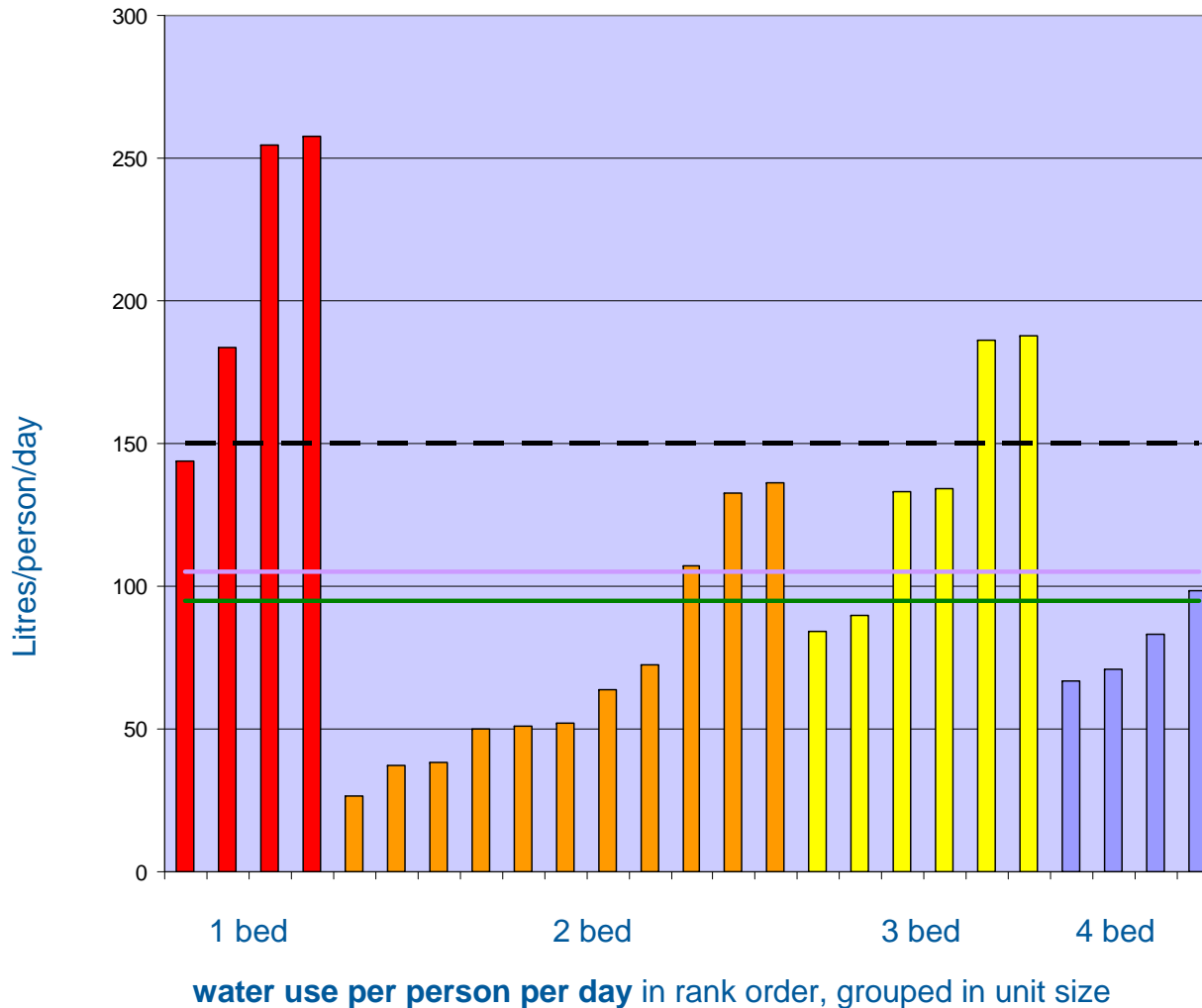

South East regional average

CSH level 4

Greenhomes standardised average water use

# passive savings

reducing electricity consumption

Dedicated low energy lighting throughout

Large windows for maximum daylight

A+ appliances where supplied

energy efficiency advice

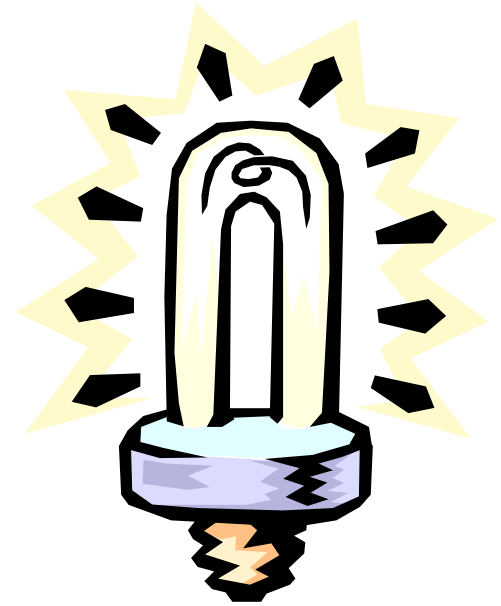

# passive savings

## Greenhomes electricity use per household per year

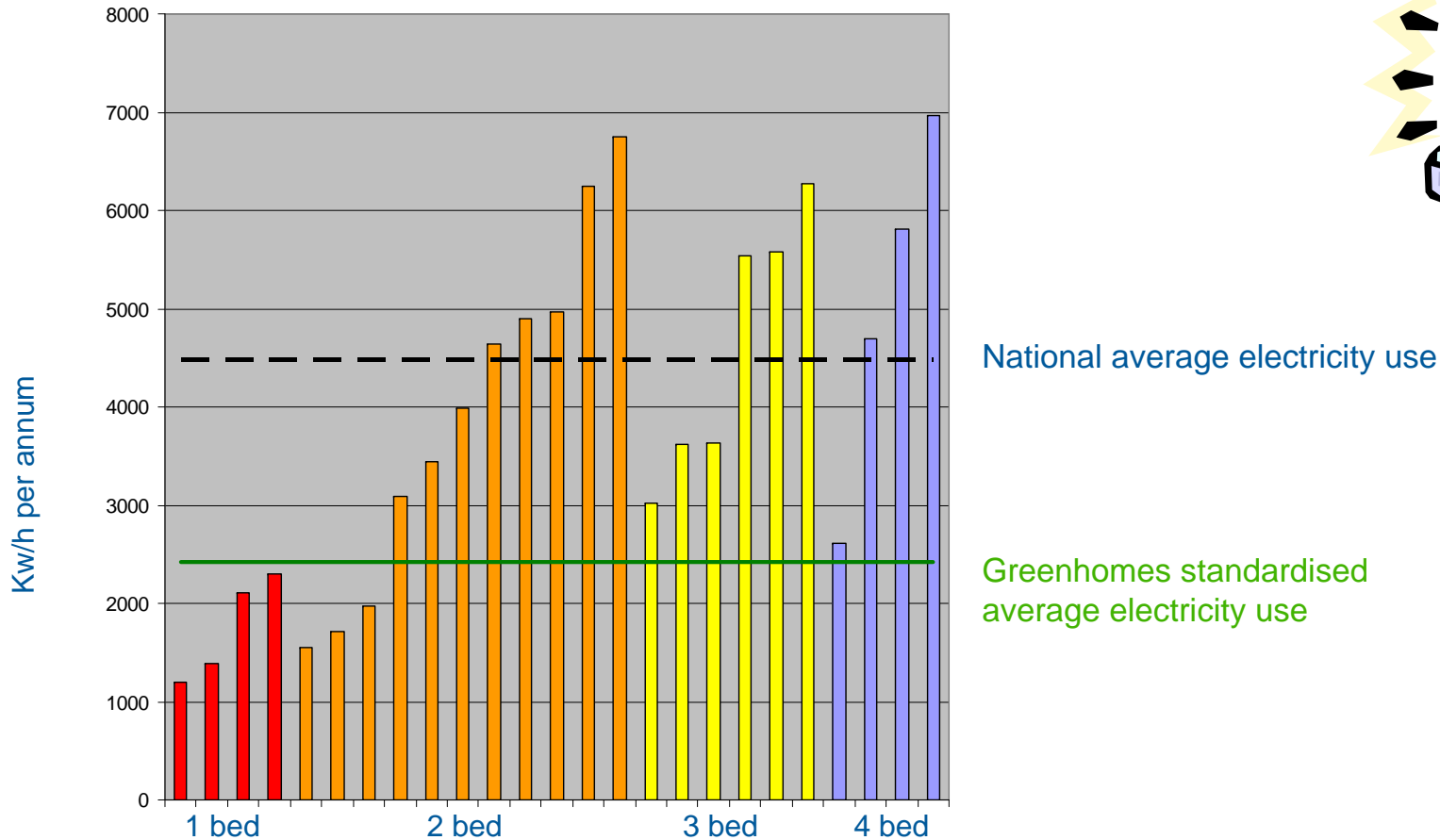
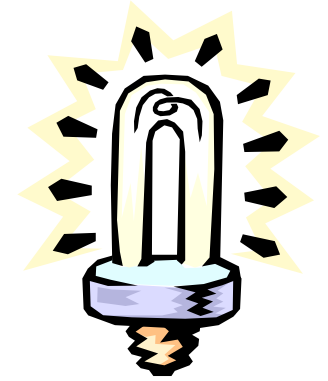

electricity use per household per year in rank order, grouped in unit size

liveability



greenhomes

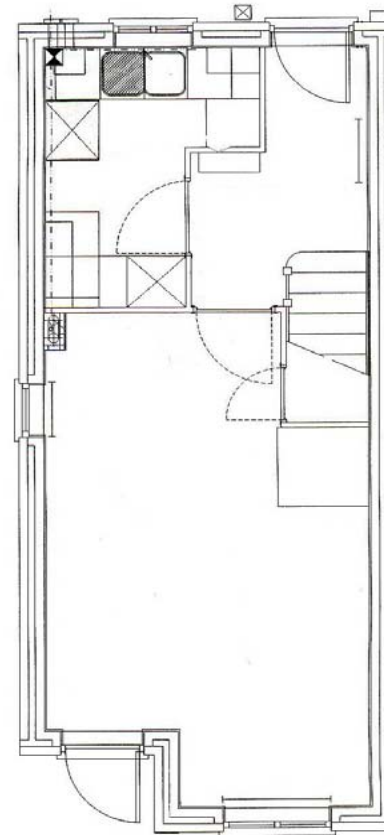

S.106 development



## gold messages



**greenoak**  
housing association

1. Board commitment
2. Organisational champions
3. Overall strategy
4. Partnership working
5. Using existing knowledge
6. Invest in research
7. Do something

...its about physics, economics, but mostly management

# What has worked for us?

## Passive approach:

Built-in not bolt-on

## Focus:

Not trying to do everything at once

## Waste reduction:

Reduce before greening the supply

## Reality monitoring:

Understanding actual usage

## Learning the lessons:

Sharing what does and doesn't work, learning from others



**Keep It Simple and Sustainable!**



**greenoak**  
housing association

**liveable solutions for a low-carbon future**

**[www.greenoakha.org](http://www.greenoakha.org)**  
**01483 747900**